

PICA CUBE™ 4C

DESIGNED BY THE BLACK TANK



Gorgeous Palette of Colors

The Pica Cube 4C packs an unprecedented 22-24 watts of output into just a 2.5 inch cube! The fixture is built on Black Tank's GEN2 controls and patented heat management technology which provides users amazing light quality and options for broad-ranging installations for archtainment, retail, museum, cruise ship and architectural applications.

Sharing the same best in class RGBW quad-chip emitters used in Pica's bigger siblings, the Miro and Braq Cubes®, a gorgeous palette of saturated, mid-tone and pale tint colors can be dialed in at the touch of a button. The single chip optic eliminates multi-colored shadows and creates a powerful, fully blended color wash wherever the designer needs it.

The Pica Cube can be powered via AC Mains (100-240VAC) using an available power-supply and controlled using standard DMX or in standalone mode via its easy-to-use on-board controls. The optional Pica Portal is capable of powering and controlling up to four Pica Cubes by providing power and data through a common Cat5 (24 AWG) cable.

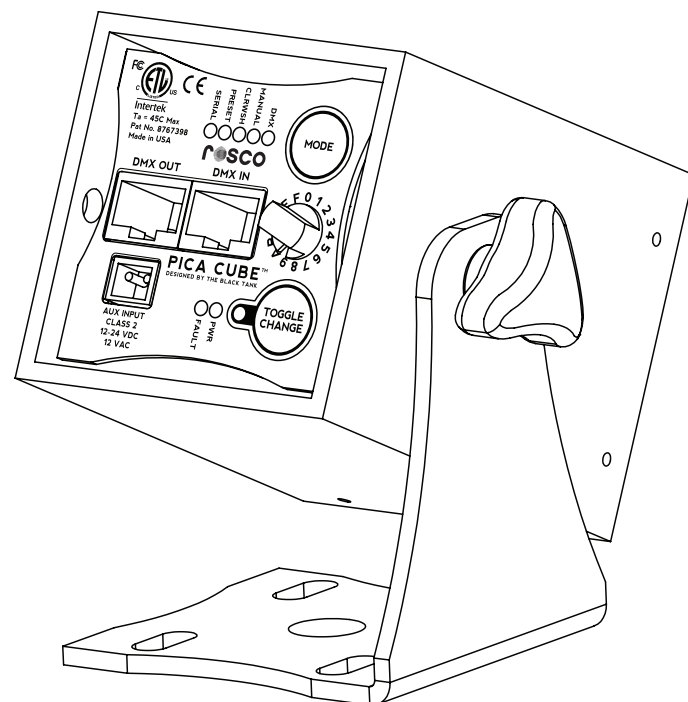

Key Features

- 4C single chip optic with homogenizing lens features superb color uniformity and fringe-free shadows
- Unique patented (US Patent No. 8,767,398) heat management system packs the most lumens into the smallest form factor
- Variable power input from 12-24VDC enables versatile power options
- Over 90 luminaires on a single 20A circuit
- Modular design easily configures in strips and arrays for maximum versatility
- Flicker-free dimming in 8 or 16 bit resolution
- Intuitive on-board controls
- Easily installed in many applications using CAT5 cable that carries Power + Data
- Full assortment of spot, medium and wide lenses included
- Novel "filament mode" mimics the delayed blackout glow of incandescent fixtures



PICA CUBE™ 4C

DESIGNED BY THE BLACK TANK



SPECIFICATIONS

Input Voltage:	12-24VDC or 12VAC
Power Consumption:	22W (DC Input) or 24W (AC Input) at 100% Output
Power Input:	Power Adapter (100-240VAC In/12-24VDC Out) or CAT5 (Power +Data)
LED:	1 x 12W Osram Multi-chip
Lumen Maintenance:	80,000 hours B50 L70 at 45C (LM-79-08 Standard)
Data:	DMX, RJ45 Connectors
Output:	285 lumens
Color Range:	4.2 billion discrete mixes (256 x 256 x 256 x 256)
Operation:	DMX: 8 or 16 bit DMX512/Manual: Rotary Knob
Operating Temp.:	-13° to 113° F (-20° to 45° C)
Humidity:	0 - 95% non-condensing
Dimensions:	2.5in x 2.5in x 3.6 in (63.5mm x 63.5mm x 91mm)
Weight:	0.9 lbs (0.41 kg)
Housing:	Powder Coated Aluminum Extrusion (1/8" wall)
Approvals:	FCC Class A Radiated and Conducted ETL / UL Standards 1573 and 8750 cETL / CSA C22.2 #166-M1983 CE / IP20 Rated

PICA CUBE ACCESSORIES

- Top Hat
- Egg Crate Louver
- Barn Doors (Set of 4)
- Mounting Hardware
- Symmetrical Diffusers
- Asymmetrical Diffusers
- Wall Power Adapter
- Pica Portal 125

PART NUMBERS

4C Black:	515 90200 1014
4C White:	515 90200 2014

WHAT'S IN THE BOX

- Pica Cube
- Set of Homogenizing & Spread Lenses
- Requires Wall Adapter or Pica Portal for power each sold separately

All LEDs On

Without Diffuser



Polar Candela Distribution

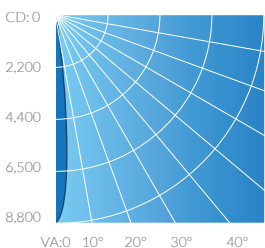

Illuminance at a Distance

Center Beam LUX	Beam Width
34,944	0.1m
8,736	0.1m
3,883	0.2m
2,184	0.3m
1,398	0.3m
971	0.4m

Beam Spread: 8°

All LEDs On

With 20° Diffuser

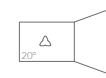

Polar Candela Distribution

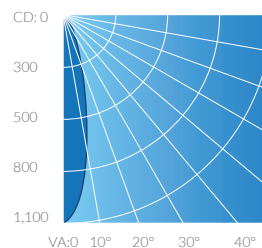

Illuminance at a Distance

Center Beam LUX	Beam Width
4,279	0.2m
1,070	0.4m
475	0.6m
267	0.8m
171	1.0m
119	1.1m

Beam Spread: 22°

All LEDs On

With 40° Diffuser

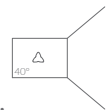

Polar Candela Distribution

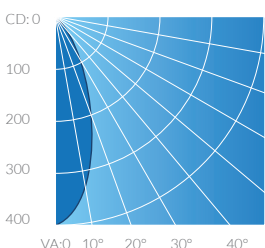

Illuminance at a Distance

Center Beam LUX	Beam Width
1,583	0.3m
396	0.6m
176	0.9m
99	1.2m
63	1.5m
44	1.7m

Beam Spread: 34°

All LEDs On

With 60° Diffuser

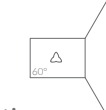

Polar Candela Distribution

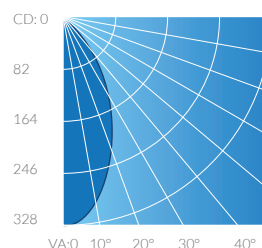

Illuminance at a Distance

Center Beam LUX	Beam Width
1,311	0.4m
328	0.8m
146	1.3m
82	1.7m
52	2.2m
36	2.6m

Beam Spread: 48°